



CAPITAL COMPACTORS & BALERS

Minimise Your Waste **Maximise Your Savings**

CS2 Static Waste Compactor

Specification

Our CS2 static compactors are mainly used for dry general waste i.e. general office waste, broken pallets, furniture, window frames, textiles, etc.

With fast cycle time, high volume charge box, heavy duty compaction and low noise levels, our static waste compactors are the perfect choice to minimise your waste costs.

Available in a range of colours, with clear operating instructions and health and safety stickers as standard. Easy to operate, safe to use and backed by a network of our own engineers to ensure maximum reliability.



Technical Information

Compaction Force	23 Tonnes
Power Requirement	32A 3Ph + N + E Socket outlet fused at 32Amp D type with local 30 Milliamp RCD protection (If you have an existing supply that doesn't match this specification, please contact technical@capitalcompactors.co.uk to check if it's usable or discuss a solution)
Motor	7.5kW
Noise Level	70dB at 3m From Unit
Cycle Time	27 Seconds
Charge Box Volume	1.75m ³
Volume Per Stroke	1.50m ³
Ram Depth	700mm
Ram Diameter	127mm
Running Hydraulic Pressure	2000psi
Pinning Hydraulic Pressure	2150psi
Overall Length	2906mm
Overall Width	1600mm (+2510mm for Personnel Safety Enclosure)
Main Frame Height	1310mm
Variant Shown	Side Bin Lift & Fully Enclosed Personnel Safety Enclosure

The details provided in our specification sheets are for your general information and use only. They are subject to change due to the continual design and build development.

Capital Compactors

Capital House, 26 Sudley Road,
Bognor Regis, West Sussex
PO21 1ER

call +44 (0)1243 837614
fax +44 (0)1243 837615
email enquiries@capitalcompactors.co.uk



www.capitalcompactors.co.uk

© Capital Compactors Ltd 2017 | All rights reserved
* Indicates a trademark registered in the UK



CAPITAL COMPACTORS & BALERS

Minimise Your Waste **Maximise Your Savings**

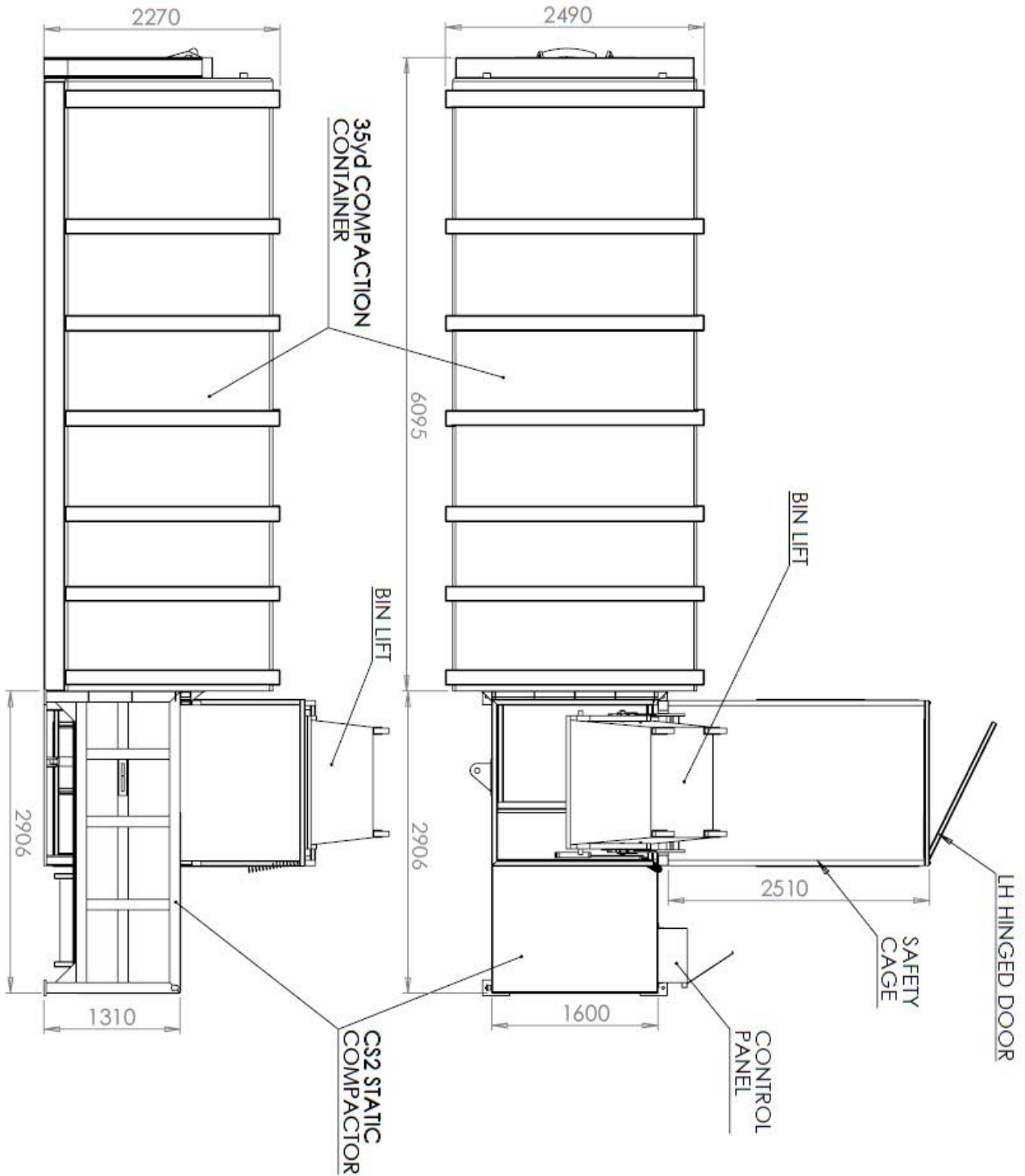

SIDE VIEW

PLAN VIEW